

HVR1C12

- High Voltage Reed Relay
- Form C Version
- Breakdown Voltage up to 4.0KV

[Outline Dimension]

Unit: mm

Scale: 1/1

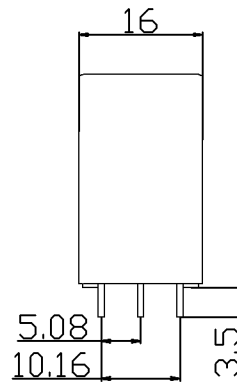
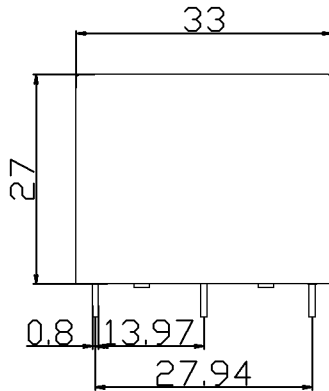

[Top View]

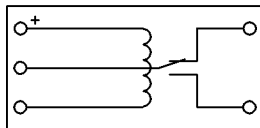

Order Information

HVR1C12

Coil Parameters		Relay Parameters	
1 Nominal coil voltage	12 VDC	1 Min Breakdown Voltage	4.0K VDC
2 Max Operating voltage	16 VDC	2 Dielectric Strength coil/contact	4.0K VDC
3 Max Pull-in voltage	9.0 VDC	3 Insulation Resistance coil/contact	1X10 ¹² ohm
4 Min Drop-out voltage	1.0 VDC	4 Operate Time, incl. Bounce	1.5ms
5 Coil Resistance	300 ohm	5 Reset Time	0.5ms
Contact Parameters		6 Capacitance Across Contacts	0.5pF
1 Max Contact Rating	100 W	7 Storage Temperature	-35 ~ +105°C
2 Max Switch Voltage	1.0KVDC	8 Operating Temperature	-20 ~ +70 °C
3 Max Switch Current	1.0 A	9 Soldering Temperature	5 sec. max 260°C
4 Max Carrying Current	2.5 A		
5 Min Breakdown Voltage	4.0K VDC		
6 Max Contact Resistance	150 mohm		

Version: 02	Designed by		TITLE High Voltage Form C	
	Checked by			
	Approved by		P/N HVR1C12	Scale: 1:1
	Date	28, May, 2012		Page: 1/1